

WALL MOUNTING: CONTINUOUS HANGER BAR (CHB) AND METAL PLATE (MP55Z) FOR TW AND ATM



APPLICATION

For wall mounting mineral board panels with Z-clips.

DESCRIPTION

This installation technique uses a factory applied 5"x5" metal plate with "Z" punch out and a continuous hanger bar fastened to the wall. Installation is as follows:

1. Locate installation points of the CHB48S, by measuring the location of the "Z" punch on the back of each panel.
2. Install the CHB48S to the wall with appropriate fasteners for the wall condition and type. Fasten to studs when possible (fasteners not provided by G&S). Allow for 3/4" reveal.
3. Lift panels so "Z" clip punchouts are above wall mounted CHB48S. Lower the panel to engage clips. Verify all clips are engaged.
4. If Safety Clips are required to prevent lifting of panels, please contact G&S Acoustics.

WALL MOUNTING DETAIL

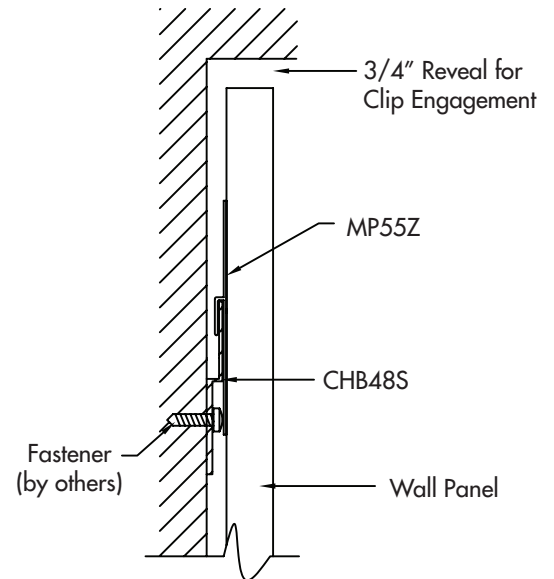

CHB48S

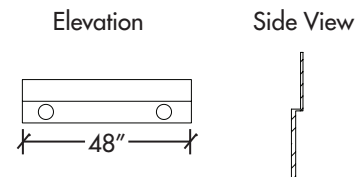

MP55Z



Controlling Sound Beautifully

800-737-0307 • 636-225-8800 • fax 636-225-2966 • www.gsacoustics.com



STANDARD LOCATIONS FOR METAL PLATES (MP55Z) ON TW & ATM PANELS

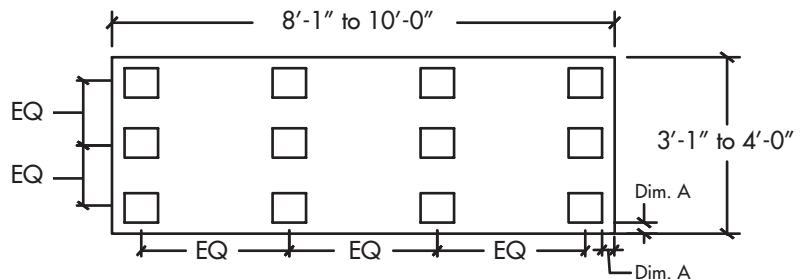
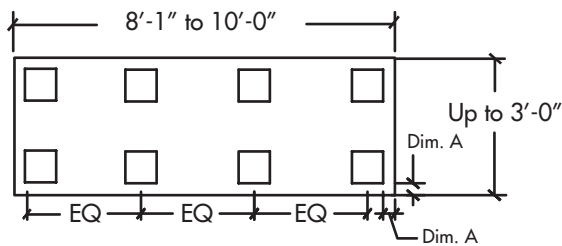
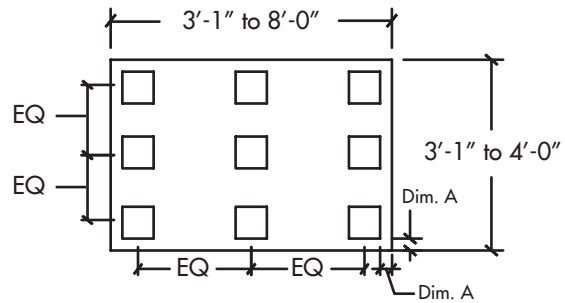
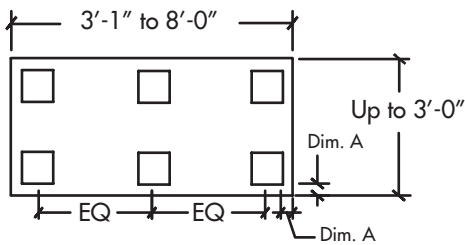
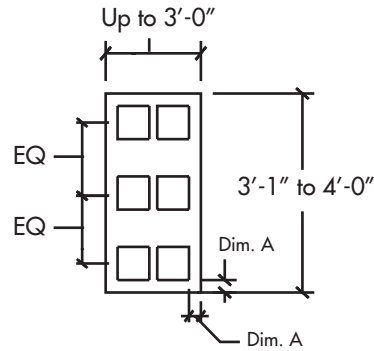
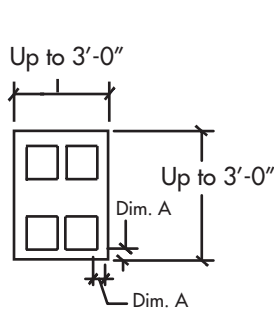

Dim. A 3" from edge

Note 3'-0" or under, remove center row

Controlling Sound Beautifully